

# Attenuator

## Polarized laser beam power attenuation

This laser beam attenuator model is a useful and flexible laboratory equipment. High power laser beams with a polarization of either p or s are attenuated gradually with a transmission of nominally 0 to 100% by manual control from the controller box or by remote control from a Windows<sup>TM</sup> environment (Software utility included). The configuration comprises a waveplate and polarizing beam splitter, resulting in undistorted beam profiles even from high power beams.

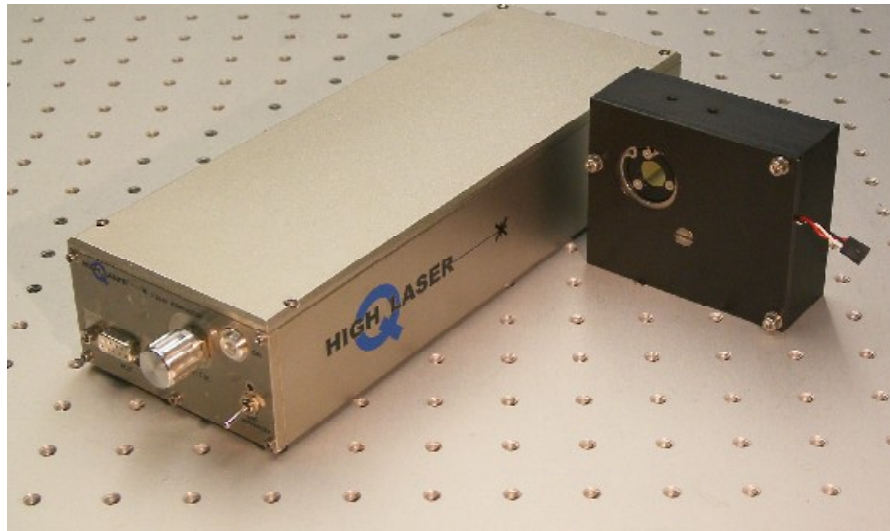

Models: Att2.0-1064  
Att2.0-1340  
Att2.0-532  
Att2.0-355  
Att2.0-266  
Att2.0-xxx

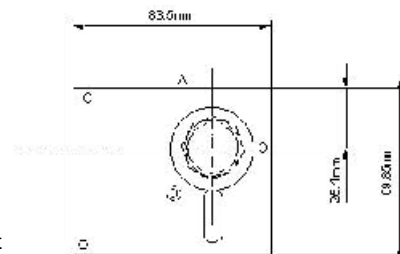

Attenuator Blueprint

### Technical Data

Transmission at 100% setting	>98%
Resolution, typical	0.5%
Accuracy, typical	1%
Usable Aperture	8 mm
Beam height	2" or 3"
Maximum Power	5 W*
Input Polarization	p or s
Output Polarization	p
Polarization Contrast Ratio	< 1:200
Controller Size	245 mm x 90 mm x 49 mm (l x w x h)
Attenuator Size	83,5 mm x 69,85 mm x 29 mm (l x w x h)

\*Beam filling aperture, inquire about higher power model option

### Inquire about

High power and high energy models  
Dual attenuation option for high accuracy attenuation

**High Q Laser**  
Production GmbH

Kästle Park, 2nd Floor  
Kaiser-Franz-Josef-Strasse 61  
A-6845 Hohenems/Austria  
T ++43 (0) 55 76 / 43 0 . 40  
F ++43 (0) 55 76 / 43 0 . 50  
E sales@highqlaser.com  
www.highqlaser.com

